

# "If we had to pour concrete, we wouldn't have purchased the spa!"

- Donna C., Brea, CA

## "NEW" STATE-OF-THE-ART



**EZ  
PAD®**



### The Highest Quality, Best-Engineered Spa Pad Available

- ❖ Convenient - Saves Time and Money
- ❖ Proven Alternative to Concrete
- ❖ Rugged Durability - Cement Grey Color
- ❖ Modular Design (4 Modules form 8' x 8' Pad)
- ❖ Expandable Sizes with Additional Modules
- ❖ Minimal Ground Preparation
- ❖ EZ Assembly - Do It Yourself



**User Friendly**



**Won't Fall Apart**



**EZ to Transport**

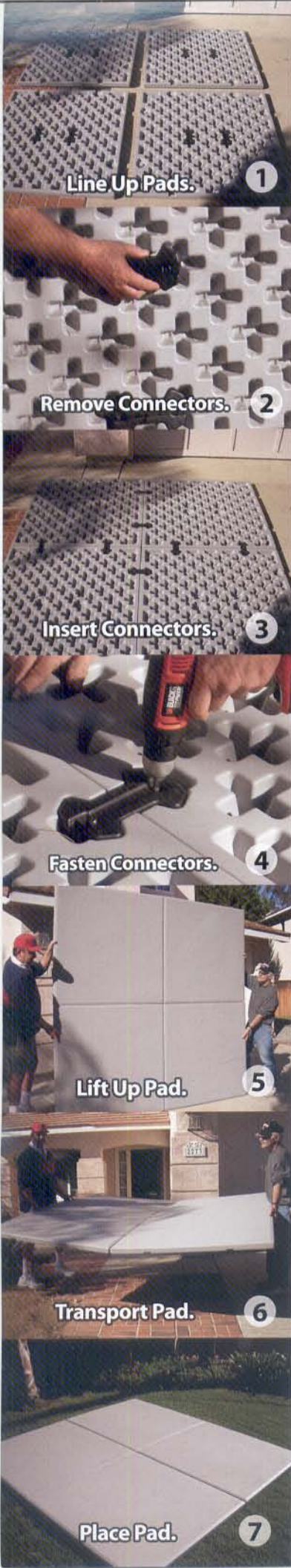

Line Up Pads. 1

Remove Connectors. 2

Insert Connectors. 3

Fasten Connectors. 4

Lift Up Pad. 5

Transport Pad. 6

Place Pad. 7

## WHAT IS AN EZ PAD?

The EZ Pad is a pre-fabricated modular platform. It is made of high-density polyethylene plastic, crush tested to well over 5,000 lbs. per square foot. The EZ Pad is rugged and durable with excellent resistance to impact and abrasion and is maintenance free.

## WHY USE AN EZ PAD?

The EZ Pad provides a solid level surface, which is required by most Hot Tub / Spa manufacturers. EZ Pad is an inexpensive and speedy alternative to pouring concrete and hiring contractors. You can place your EZ Pad on any level well-drained area, including grass, dirt, sand and gravel. It is also a simple way to extend your patio or deck space.

The demand for this product (thousands sold) has proven that consumers desire a convenient and inexpensive solution to spa placement dilemmas.

Our customer's feedback is the driving force behind this state-of-the-art EZ Pad. They spoke and we listened.



8' x 8'  
4 Modules

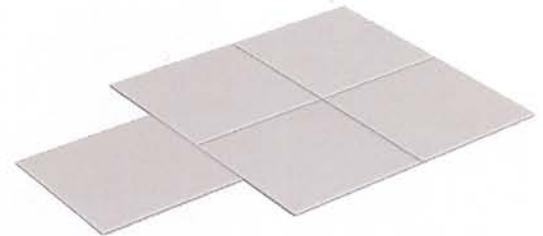

8' x 8' w/ Porch  
5 Modules



8' x 12'  
6 Modules

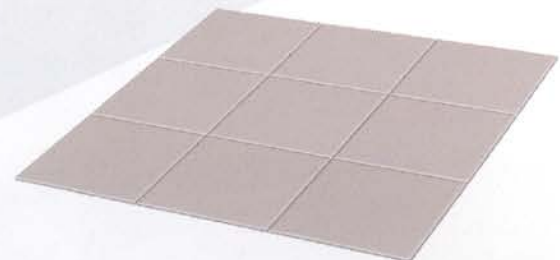

12' x 12'  
9 Modules